



**SL-208**



## I. FEATURE

- Available in a selection of LED light colors
- Compatible with traditional Lamp E-27
- Standard E-27 base and no need of modification
- E-27 is the lightest in the market currently (64.8g)
- voltage operation at 100V-240V
- Excellent thermal performance
- Beam angle at 15° or 30° degree
- Safety Standard: CE
- No UV

## II. Typical Applications

- Entertainment lighting
- Architectural lighting
- Landscape lighting
- Bollards / Security / Garden lighting
- Aluminum

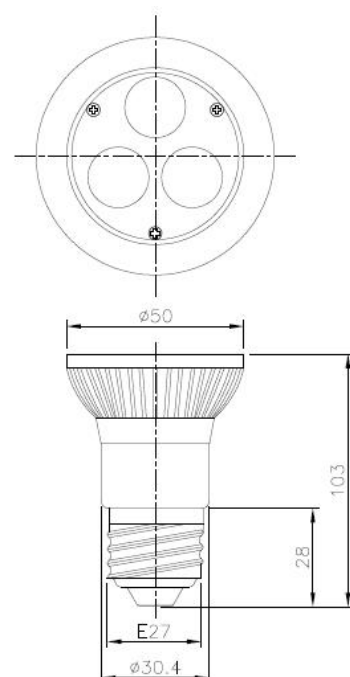

### III. THE PRODUCT

- Operating Voltage: 100V-240V 50/60 Hz
- Bottom base: PC, flammability: V2 level
- Heat sink: Aluminum alloys, 55~65°C after heat balance ( $T_j = 25^{\circ}\text{C}$ )
- Operating Temp. : -10~40 °C

E-27 Power	Led	Lumi	Beam Angle	Color	Part No.
5.0W	1W*3	135-165	30° or 15°	Red	SL-208(5W-R)
5.0W	1W*3	150-165	30° or 15°	Green	SL-208(5W-G)
5.0W	1W*3	30-45	30° or 15°	Blue	SL-208(5W-B)
5.0W	1W*3	105-120	30° or 15°	Amber	SL-208(5W-Y)
5.0W	1W*3	240-300	30° or 15°	Warm White	SL-208(5W-WW)
5.0W	1W*3	240-300	30° or 15°	White	SL-208(5W-W)

#### Photometrics

Ambient Operating Temperature,  $T_j = 25^{\circ}\text{C}$

Color	Dominat Wavelength		Half-Width (nm)
	Min. (nm)	Max. (nm)	
Red	620	630	25
Green	520	530	35
Blue	460	470	25
Amber	585	595	25
White	6000K	7000K	
Warm White	2800K	3800K	